



DISCOVER FIJI

Small Ship Island Cruises



captaincookcruisesfiji.com

FIJI ISLANDS

Welcome to the casually elegant world of Captain Cook Cruises Fiji. Leave the crowds behind aboard your small ship carrying fewer than 130 privileged guests and 60 crew. No lines. No waiting. Just a warm and intimate ambiance you won't find on larger cruise ships.

With 330 remote Fiji islands waiting to be explored, our adventurous itineraries offer an authentic and personal experience. Fiji's people are the most welcoming in the world. It is where happiness finds you.



CRUISING WITH US

Sail right into the heart of remote villages, hidden coves, and snorkel reefs where only MV Reef Endeavour is welcomed. We work closely, and maintain strong relationships with the local people. Our discovery itineraries are expertly designed to allow you to share intimate moments away from the crowds. Immerse yourself in local culture and cuisine, and have behind-the-scenes experiences.



OUR CRUISES INCLUDE:



All meals



Daily snorkel, kayak, SUP



Local food & culture



Island tours & hikes



Entertainment



24/7 coffee & tea facilities



Kids Club inc early dinner (5-9yrs)



Boat & bus transfers

ADDITIONAL FEATURES

Reef Endeavour small ship experiences include features you wouldn't expect on a big ship:

- Most twice-daily excursions included
- Freshwater swimming pool, sauna & Sundeck jacuzzi
- Choice of 4 recently renovated accommodation levels
- Senikai Day Spa - Massage & beauty - optional
- Scuba Diving (PADI 5 star) daily - optional
- Mini-gym & audio visual room/library
- Child age 5-17yrs (under 5yrs aren't accepted)
- Easy access small boat launching platform
- Interconnecting family Staterooms and family quad cabins
- Resident marine biologist cultural & marine presentations.

Fares include all of the above except drinks, optional tours & services. Prices may be subject to change due to fuel price fluctuations.



MAMANUCA & YASAWA ISLANDS

Join Captain Cook Cruises for voyages of discovery across turquoise waters to unspoilt islands where the cool shade of swaying palms fan over white sand. Meet Fijians in traditional villages, explore their culture & swim in warm crystal clear water over coral reefs teeming with life all from your floating resort, MV Reef Endeavour.

The Yasawa and Mamanuca Islands are famous for their incredible limestone lagoons, dramatic topography, and welcoming people. This is where happiness finds you.



3 NIGHT DISCOVERY CRUISE

MAMANUCA & SOUTHERN YASAWA ISLANDS

Our 3 night cruise to the Mamanuca and Southern Yasawa Islands visits Monuriki where Castaway was filmed, uninhabited Sacred Islands and the spectacular volcanic island, Waya.

Free pick-up from most Mamanuca island resorts.

3 NIGHT YASAWA ISLANDS CRUISE

Check in	Saturday 12.00pm weekly – Port Denarau, Nadi
Return	Tuesday 9.00am – Port Denarau, Nadi

4 NIGHT DISCOVERY CRUISE

NORTHERN YASAWA ISLANDS

The 4 night cruise explores the remote northern Yasawa islands from Naviti to Yasawa including the famous Sawa-i-lau limestone caves and aquamarine lagoon. Meet the children of a local school and dive and snorkel some of the most pristine reefs in the group.

4 NIGHT YASAWA ISLANDS CRUISE

Check in	Tuesday 12.00pm weekly – Port Denarau, Nadi
Return	Saturday 9.00am – Port Denarau, Nadi

7 NIGHT DISCOVERY CRUISE

MAMANUCA & YASAWA ISLANDS

Our most popular cruise explores Fiji's majestic Mamanuca and Yasawa Islands for 7 nights. Situated off the north-west coast of the main island and being volcanic in origin, the Yasawa Islands offer some of the most dramatic scenery in the South Pacific.

Our 7 night cruise combines the 3 & 4 night cruises for the ultimate Mamanuca and Yasawa islands experience. With a new island and coral reef to visit every morning and afternoon this cruise offers exciting beach, water and cultural activities.

7 NIGHT YASAWA ISLANDS CRUISE

Check in	Tuesdays & Saturdays 12.00pm – Port Denarau, Nadi
Return	Tuesday & Saturdays 9.00am – Port Denarau

“The 7 day Yasawa cruise is a must. The crew are super friendly & the small boat makes it easy to get to know passengers. Lovely stops to snorkel at or just laze on a beach. This is a relaxing holiday where you unwind & forget about the rest of the world!”

John, NZ, January 2017

Mamanuca & Yasawa Islands Cruise Highlights

In addition to our standard cruise inclusions (see page 2) your Mamanuca & Yasawa Islands Cruise includes:

- Snorkelling, glass bottom boat & scuba diving opportunities most mornings & afternoons
- Visit an island village & school, meet the locals and visit a handicraft, flower & shell market
- Special village choral church service (Sun)
- Captain's welcome cocktails & dinner
- Island Night, kava, meke & lovo feast.

Optional Adventures:

- Swim in the Sawa-i-lau limestone caves (7 & 4 night cruise)
- 5 Star PADI Scuba Diving.

Dive sites we visit:

- Babylon Caves (max 22m)
- Cabbage Patch (max 20m)
- Tavewa breakers (max 22m)
- Golden nugget (max 20m)
- The Zoo (max 30m)
- The Maze (max 22m)
- Smurfs (max 18m)
- Garden of Eden (max 18m)

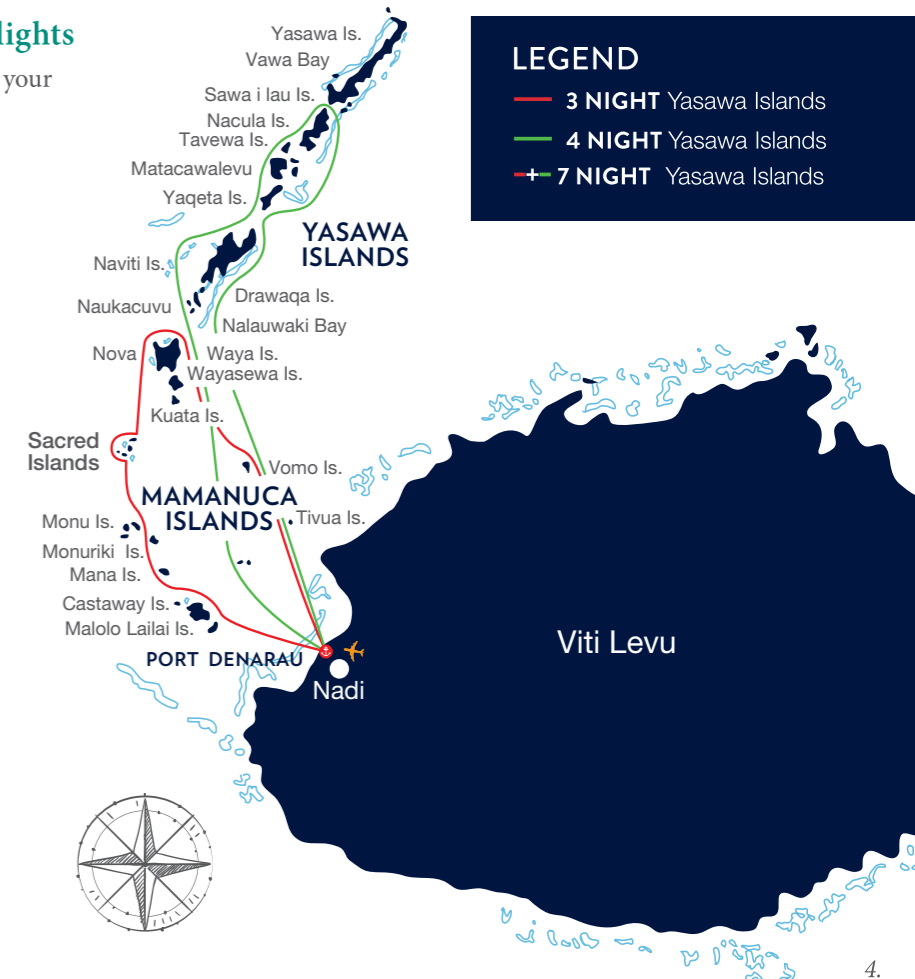

LEGEND

- 3 NIGHT Yasawa Islands
- 4 NIGHT Yasawa Islands
- + 7 NIGHT Yasawa Islands

REMOTE NORTH & LAU GROUP

On the first Tuesday of each month Reef Endeavour departs Port Denarau for 7 to 11 nights on one of 3 amazing voyages of Discovery to places without postcards.

Discover colonial Fiji visiting the old capital, pearl farming town and 180th meridian or take a voyage circumnavigating Vanua Levu and experiencing the 4 very different cultures of Fiji or visit remote Lau where people of Tongan Heritage only see a supply boat every 6 weeks.

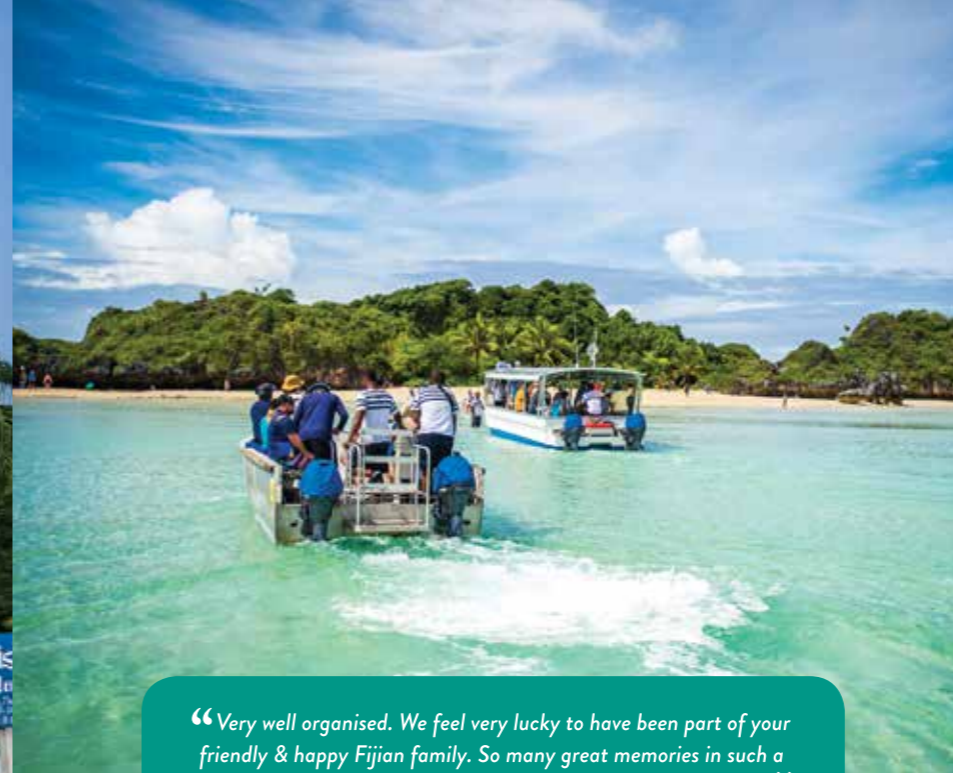

“Very well organised. We feel very lucky to have been part of your friendly & happy Fijian family. So many great memories in such a short time. Our first cruise has been magnificent, we will be back.”

C&P, NSW Australia, Oct 2016



Tavoro Falls

7 NIGHTS

COLONIAL FIJI DISCOVERY CRUISE FIJI'S REMOTE NORTH

Discover remote Northern Fiji and explore the coast of Viti Levu, Fiji's main island. Visit the old capital of Fiji, the world heritage listed town of Levuka, on the island of Ovalau. Meet the people of this quiet historic town with its stately backdrop of 19th Century colonial architecture, a time capsule of colonial rule.

Swim at Tavoro Falls in the Bouma Heritage park on the garden island of Taveuni and stand on the 180th meridian, the natural dateline. Be welcomed in to a local village where you will enjoy a lovo feast & meke.

Our journey takes you to Savusavu's extinct volcanic crater, hot springs, natural pearl farm and thriving markets. We explore remote coral cays, accessible only by ship such as Nananu-i-ra for extraordinary snorkelling, glass bottom boat and scuba diving.

Optional Adventures

- Scuba Dive remote reefs including the Rainbow Reef
- Levuka; your choice of 3 historic town tours
- Savusavu; pearl farm tour, river tubing, mountain biking.

7 NIGHT COLONIAL FIJI CRUISE

Check in	Tuesday 12.00pm – Port Denarau, Nadi
	2017 - 4 Apr, 6 Jun, 1 Aug, 3 Oct, 5 Dec
	2018 - 3 Apr, 5 Jun, 7 Aug, 2 Oct, 4 Dec
Return	Tuesday 9.00am – Port Denarau, Nadi

7 NIGHTS

4 CULTURES DISCOVERY CRUISE FIJI'S REMOTE NORTH

Circumnavigate Vanua Levu – Fiji's second largest island – and explore the islands, rivers and rainforests of the remote north. On the way meet the local people of the four different cultures of Fiji, the Elice (Polynesian), Banaban (Micronesian), Indian and the Fijian (Melanesian) people. Snorkle and dive the Great Sea Reef - the world's third largest barrier reef.

Travel by local bus to Labasa, Vanua Levu's largest town. This remote northern trading town's market will amaze you with a myriad of natural produce and aromatic spices.

Be welcomed into a local village by the Chief, enjoy a lovo feast and meke (Fijian Dance). This concludes an amazing journey to Fiji's remote north.

Optional Adventures

- Labasa - River tubing or Mountain biking
- Scuba dive the Great Sea Reef and other remote Vanua Levu reefs.

7 NIGHT 4 CULTURES CRUISE

Check in	Tuesday 12.00pm – Port Denarau, Nadi
	2017 - 5 Sep
	2018 - 2 Jan, 1 May, 3 Jul, 4 Sep
Return	Tuesday 9.00am – Port Denarau, Nadi

LEGEND

- 7 NIGHT Colonial
- 7 NIGHT 4 Cultures
- 11 NIGHT Lau Discovery

Dive sites we visit:

- Golden Dream (18m)
- Shark Alley (24m)
- Levuka Pipeline (30m)
- Golden Nuggets (20m)
- Great White Wall (30m)
- Purple Wall (26m)
- Rainbow Reef (20m)

FIJI ISLANDS

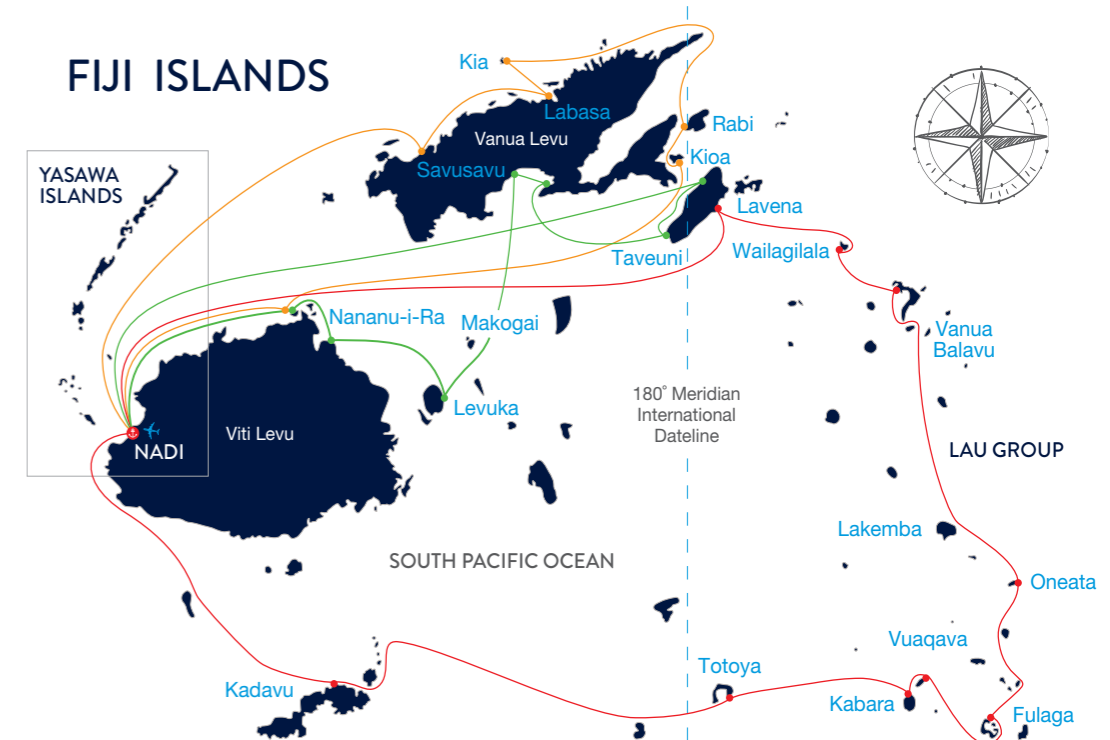

LAU GROUP & KADAVU



11 NIGHTS LAU & KADAVU DISCOVERY CRUISE

Embark on a voyage of discovery to a part of Fiji rarely seen by tourists - the Lau Islands and Kadavu.

Departing from Port Denarau, Nadi, the first stop is Makogai Island. Once a leper colony, Makogai is now a centre for giant clam and turtle conservation. Next is Lavena on the southern coast of Taveuni where waterfalls empty directly into the sea and you can hike for a freshwater swim. We cruise on to the most northern island of Lau - Wailagilala where we will explore the island, the ruin of an old light house, nesting turtles, snorkel untouched reefs.

From here we cruise to the nearby Qilaqila, known for its pristine waters and mushroom shaped islands. Explore some amazing caves and incredible reefs in aqua lagoons.

Continuing on we pass Lakeba & Moce to Oneata where the village invite us to their Church on the hill. Fulaga is our next stop. This amazing lagoon is too narrow for us to navigate so we launch the small boats off shore and explore its crystal lagoon and amazing corals. We then visit uninhabited Vuaqava and its central lake where you can explore and view turtles, snakes & amazing bird life.

Be welcomed by the villagers on the island of Kabara known for their wood turning and Tongan heritage. Experience a traditional Meke, Sevusevu & lovo quite different from the traditional Fijian.

We head on to horse-shoe shaped Totoya island to visit a local school and meet the children. Next stop is Kadavu, famous for its wildlife and underwater world.

Most days offer the opportunity to snorkel, swim and Scuba Dive the pristine waters of the beautiful Lau group.

Included Cruise Highlights

In addition to our standard cruise inclusions (see page 2.)

Your Lau Discovery Cruise includes:

- Cultural, Navigation and Marine talks
- Experience remote islands with Tongan heritage and culture
- Amazing aqua lagoons and Mushroom shaped islands
- Traditional ceramics in Kadavu
- Exploration of islands not seen by tourists.

Optional Adventures

- Scuba Diving some of Fiji's most remote reefs
- Local Fishing trip in Kadavu
- Mini-bus to the Waterfall at Kadavu.

11 NIGHT LAU & KADAVU DISCOVERY CRUISE	
Check in	Tuesday 12.00pm – Port Denarau, Nadi 2017 7 Nov 2018 6 Mar, 6 Nov
Return	Saturdays 9.00am – Port Denarau, Nadi

MV REEF ENDEAVOUR

The MV Reef Endeavour is an intimate small ship. She caters to 130 passengers, ensuring every guest receives personal attention in an informal, social atmosphere.

Small ship cruising allows passengers greater shore access. We visit new and exciting destinations daily. Our easy access hydraulic platform, makes it quick and easy to board and disembark for passengers of all ages.

Facilities

Swimming pool, spa, sun deck, jacuzzi and mini gym; glass bottomed-boat, snorkeling and dive vessels; two bars, two lounges and a single-sitting dining saloon; day spa, gift shop, chart house, library, free Wi-Fi (when in range) guest laundry and 24 hour coffee and tea facilities.

MV Reef Endeavour deck plans

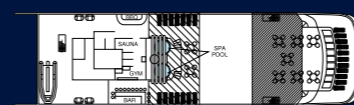

Sun Deck



A Deck - Top Deck



B Deck

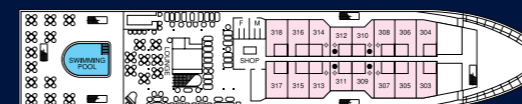

C Deck

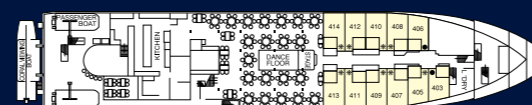

D Deck

Legend

All rooms have twin beds convertible to double bed unless indicated as follows:

- Double bed
- ◆ Connecting Family Staterooms
- ◆ Twin beds
- * Family Cabins – twin single beds plus two upper Pullman berths

Technical details

Registry: Fiji Islands
Tonnage: 3,125 tonnes
Length: 73 metres
Beam: 14 metres
Draft: 3.6 metres
Speed: 13.5 knots



Accommodation

The MV Reef Endeavour has 63 recently refurbished Tabua Suites, Staterooms and Cabins. Every cabin features a bathroom ensuite, air con, hair dryer, 240 volt power, international shaver point, Pure Fiji soaps, shampoo & towels serviced daily. Each cabin is approximately 14 sqm. Tabua Suites are approx 28 sqm. Staterooms and Suites open onto the outside deck and have two windows.

- Tabua Suites (4) feature a bedroom (twin/double) with a separate lounge, chair, lounge, desk, TV & DVD player, in room Wi-Fi, refrigerator, tea & coffee facilities and second bathroom.
- Connecting Family Staterooms (6) located on A & C decks (twin/double).
- C Ocean Staterooms (16) located on C deck
- B Ocean Staterooms (33) located on A & B deck.
- Porthole Cabin (10) open onto an inside passageway (twin/double/bunk triple/bunk quad).



Tabua Suite



Tabua Suite (Lounge)

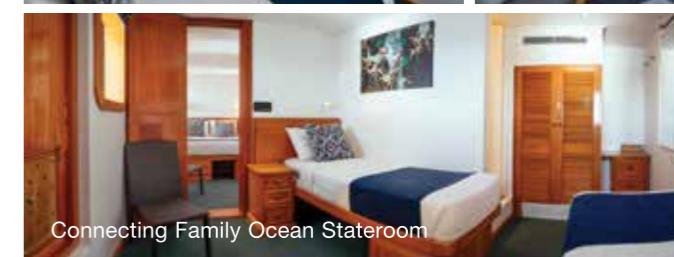

Connecting Family Ocean Stateroom

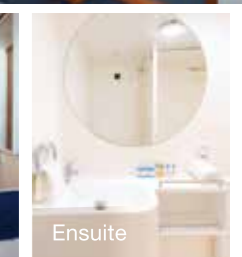

Ensuite



Porthole Cabin - Family 4 berth

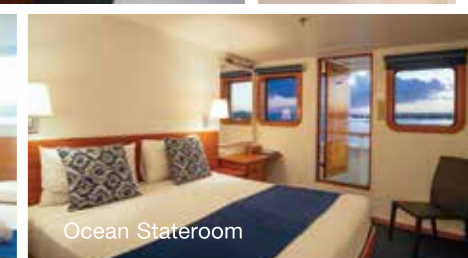

Ocean Stateroom

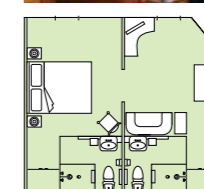

Tabua Suite

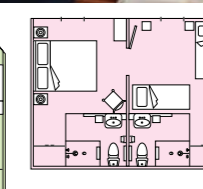

Family Stateroom A & C deck

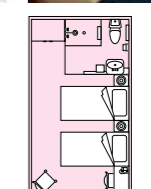

C Ocean Stateroom

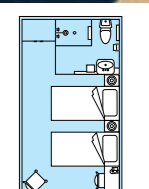

B Ocean Stateroom



Porthole cabin

WEDDINGS, ROMANCE & EVENTS



PADI SCUBA DIVING



WEDDINGS

Whether your ideal wedding day is for two on a remote beach or on your own private island of Tivua, with 200 of your closest friends, Captain Cook Cruises will make your day just as you want it to be. Discover why Fijians are the world's best hosts and enjoy the romance of these beautiful islands for your dream wedding.

Our wedding and vow renewal packages can be tailored to your needs. All of our weddings include;

- A dedicated wedding planner to make your day perfect.
- Marriage Ceremony performed by a celebrant on your cruise, either on board Reef Endeavour, Fiji One or Ra Marama or on the tropical beach setting of Tivua with Fijian singer and guitarist accompaniment
- Bride's teardrop/trailing orchid bouquet, box of petals, Groom's buttonhole flower, bottle of sparkling wine & wedding cake
- Marriage certificate
- Ask about our Photography & hair & make-up packages.

FUNCTIONS & EVENTS

We offer a comprehensive range of private event venues for 2 to 500 guests. Our fleet of 5 ships and an island, only an hour sail from Denarau, cater to every function imaginable.

- Cocktails & Dining
- Island transfers and full day Sailing events
- Team Building, Theme Events & Culture
- 3, 4 or 7 night events for up to 130 passengers
- Birthdays, Anniversaries or any family celebrations.

ROMANCE & SPA

There are Senikai Spas for beauty and massage on Tivua Island and aboard Reef Endeavour. Why not pre-book some extra relaxation. Spa packages include:

- 15 minute Senikai massage each
- His and hers Senikai Essence of Viti gift pack
- Bottle of sparkling wine on arrival
- Private Deck Dinner.

Reef Endeavour and Tivua Island day cruises offer dive opportunities with Viti Water Sports for certified, occasional and first time divers.

We are a 5 Star PADI dive facility offering up to 3 dives daily.

- For first time divers, a gentle entrance from the shores of a tropical island will see you exploring the spectacular fringing coral reefs
- Swim throughs, caves, coral bommies and breathtaking coral gardens are some of the highlights you may experience
- Dive sites will vary depending on the cruise and conditions and most are accessed by small boat.



NEW ADVANCED WRECK DIVE "RAIYAWA" AT TIVUA ISLAND

If you can't join one of our Small Ship Cruises but don't want to miss out on the amazing diving that Fiji offers, then take our Day Trip Dive Safari to Tivua Island.

Tivua Island is a coral atoll surrounded by 500 acres of coral reef so offers a variety of dive experiences including the new MV Raiyawa wreck dive.

Raiyawa was built in 1982 in Fiji and was a government vessel deployed in placing and maintaining Navigational marks around Fiji and also used to carry passengers inter-island. In 2014 Raiyawa was decommissioned and extensive work was done to ensure she was safe for diving. Work included opening large swim throughs in her hull and superstructure, as well as removing any hazards to divers such as sharp edges and obstructions. She was extensively cleaned and prepared in line with the environmental guidelines.

Passengers on Captain Cook Cruises Island Day cruise, and M.V. Reef Endeavour Small Ship cruise itineraries will have the option of diving at the "Raiyawa" wreck.

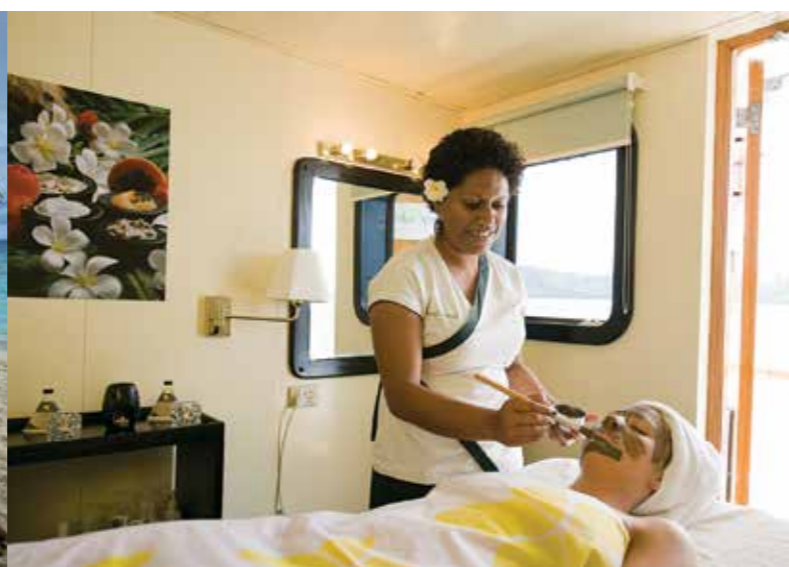

DAY & DINNER CRUISES



TIVUA ISLAND DAY CRUISE

DEPARTS DAILY - 10AM - 5PM

Set sail for a days island adventure aboard your tall ship. Your one day cruise includes all activities; guided snorkelling of clam gardens & coral plantation, glass-bottomed boat tour, use of kayaks, snorkelling gear, SUPs and volleyball:

- Kava ceremony, music and entertainment
- Morning and afternoon tea
- Tropical buffet lunch
- Beer, wine and soft drink whilst on the island
- Return Nadi & Denarau hotel transfers
- Coral Coast transfers small additional charge
- Kids activities in the Captain's Kid's Club
- Massage and hair braiding - Optional
- PADI Five star diving (Discover Scuba and advanced wreck dive) - Optional.

LAZY LUNCH CRUISE

DEPARTS DAILY - 12.30PM - 6PM

Set sail aboard our iconic tall ship to the magical Tivua island. The cruise includes all food and drinks whilst on the island together with all activities offered in the day cruise. Guaranteed to be a great day out for the whole family.

SUNSET DINNER CRUISE

DEPARTS DAILY - 5.30PM TO 8.30PM (5PM JUN-SEP)

Cruise into a Pacific Island sunset with a complimentary welcome drink and a great BBQ Dinner. Fijian cultural entertainment and spectacular scenery round-off a perfect evening on the water. Complimentary transfers from Nadi & Denarau hotels.

All day and dinner cruises can be booked open dated so you decide when you go.

Your Travel Agent

RESERVATIONS

Captain Cook Cruises Fiji

Captain Cook Cruises Building
Port Denarau Marina
PO Box 23, Nadi Town, Fiji Islands
P - +679-670 1823
F - +679-670 2045
E - nadi@captaincookcruisefiji.com

Reservations Australia

P - +61 2 9126 8160 / 1300 86 3454
E - fiji@captaincookcruisefiji.com

New Zealand - Travel Agents only

P - +64 2 163 1474
E - nz@captaincookcruisefiji.com

United Kingdom

P - +(44) 1787 211 668
E - uk@captaincookcruisefiji.com

Tusna Pty. Ltd. trading as:
Captain Cook Cruises Fiji
PO box 349, Milsons Point
NSW 1565 Australia

ABN 63 001 364 487



facebook.com/CCCFiji



@captaincookfiji



@CCCFiji